

05163200 - LT-S D40 ER32F H80 MU

| | |
|------------------------------|--|
| Type | LT-S Tool holder straight |
| Mounting | CYLINDRICAL SHANK 40 |
| Tool output | Collet nut ER 32 F - internal nut |
| Coolant | External coolant |
| Direction of rotation | r1 r2 |
| Max speed [rpm] | 6000 |
| Max torque [Nm] | 63 |
| Ratio | 1:1 |
| H [mm] | 80,5 |
| Accessories | |
| Notes | N.A. |
| Mounting tips | Not suitable for every application, please check |

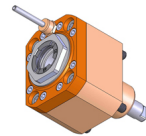

Always check live tool dimensions on the turret

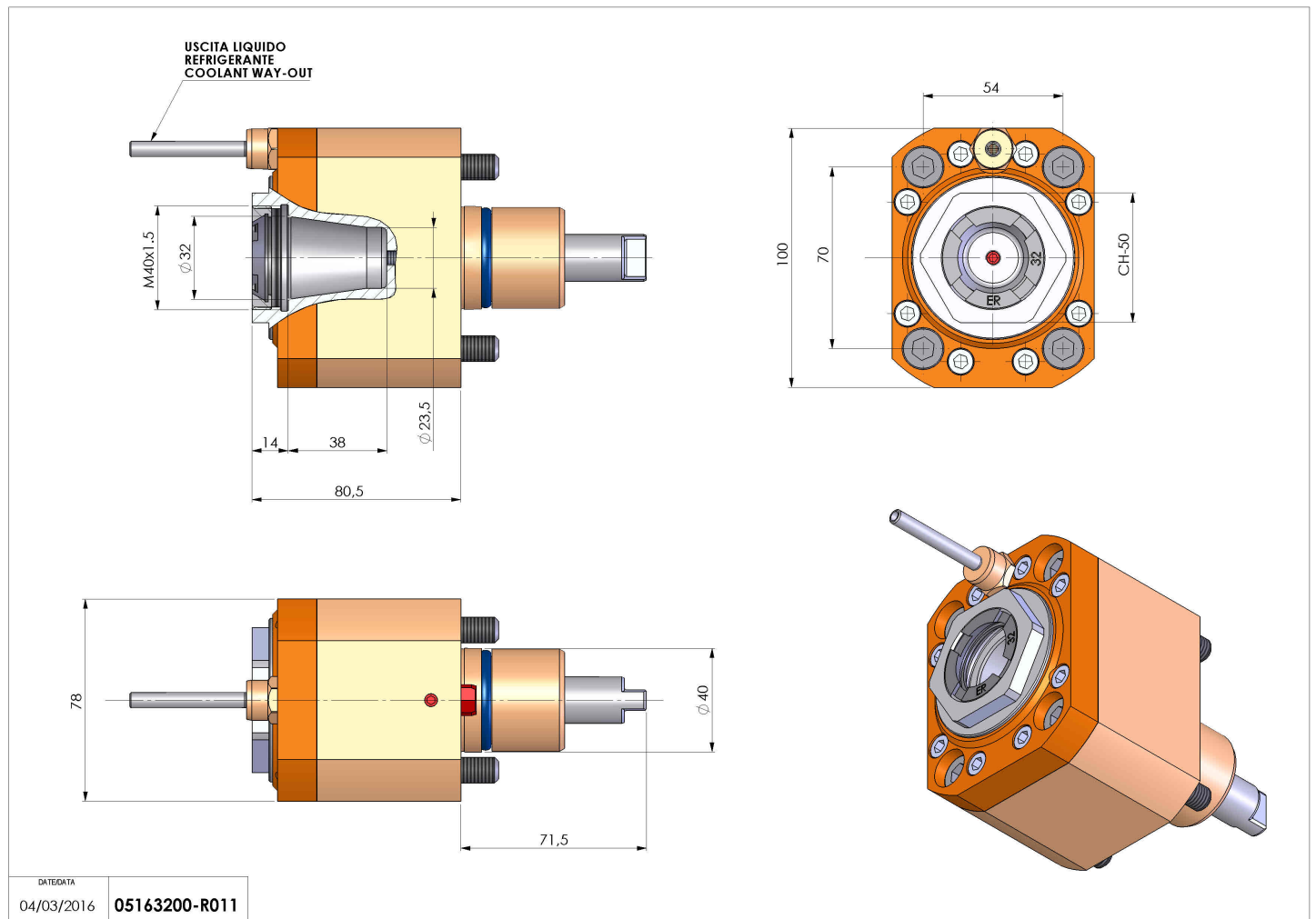

| | |
|---------------|------------|
| DATE/DATE | 04/03/2016 |
| 05163200-R011 | |

Subject to technical changes