

# 05059800 - LT-S VDI50ER32OFS60 1:2 KRH145

<b>Type</b>	LT-S OFS Tool holder straight offset
<b>Mounting</b>	VDI 50
<b>Tool output</b>	Collet nut ER 32
<b>Coolant</b>	With coolant kit
<b>Offset [mm]</b>	60
<b>Direction of rotation</b>	r1 ↻ r2 ↻
<b>Max speed [rpm]</b>	in 6000 / out 12000
<b>Max torque [Nm]</b>	in 160 / out 80
<b>Ratio</b>	1:2
<b>H [mm]</b>	145
<b>Accessories</b>	N.A.
<b>Notes</b>	N.A.
<b>Mounting tips</b>	Not suitable for every application, please check

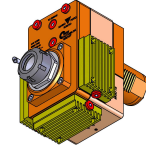

**ATTENZIONE: VERIFICARE L'ORIENTAMENTO DELLA DENTATURA VDI**

Always check live tool dimensions on the turret

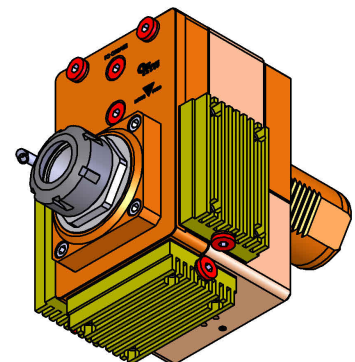
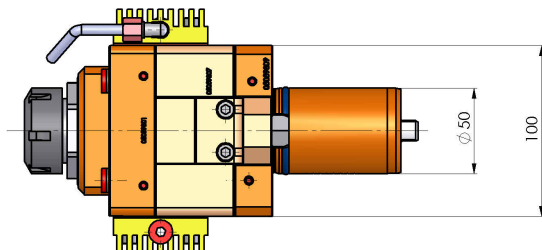
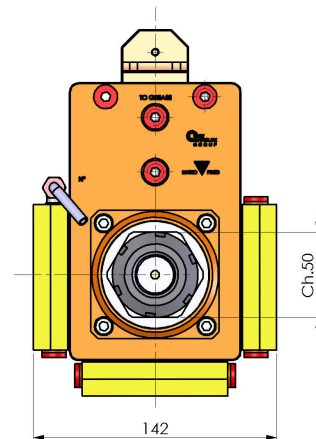
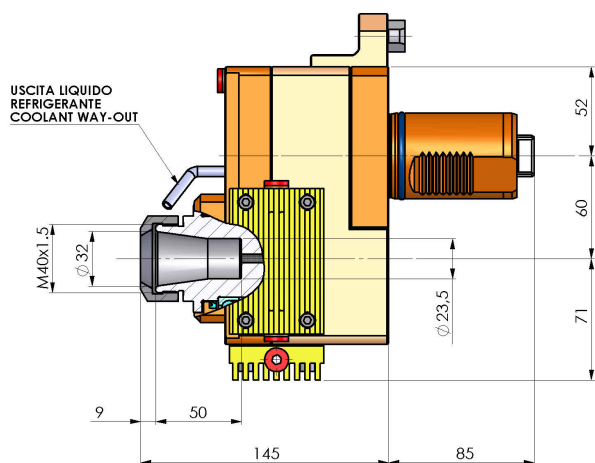

DATE/DATE  
08/09/2015 05059800-R011

Subject to technical changes